

Stainless Steel XD Heavy Duty Free-Standing Enclosures with External Disconnect Enclosures Installed

Application -

Designed to house the main power supply in external enclosure on the right side of main enclosure, keeping the live side of the power supply separate from the primary electrical equipment. Provides protection from dirt, dust, oil and water and can house most standard type disconnects. For Installation information consult our Installation Manual at www.saginawcontrol.com.

Construction -

- 0.104" stainless steel Type 304.
- Seams continuously welded and ground smooth.
- Flange trough collar around all sides of door opening.
- Body stiffeners in large enclosures for extra rigidity.
- Heavy duty lifting eyes anchor into reinforced top.
- Removable center posts permit easy sub-panel installation.
- Concealed hinges.
- Black zinc die cast padlocking handles.
- 3-point latching mechanism.
- Large removable print pockets.
- Oil-resistant gasket.
- Removable panels mount on collar studs.
- Defeater on master door requires a screwdriver to open.
- Mechanical interlock activated by the External Disconnect Prevents main door of the enclosure from being closed unless the EXD enclosure is first closed.
- Mechanical interlock activated by master door prevents slave doors from being opened first. Doors can be closed in any order.
- Ground stud on door and body.
- Provisions for light kit.

Disconnect switch (or circuit breaker) and operating mechanism are not furnished with enclosure.

Finish -

#4 brushed finish on all exterior surfaces. Sub-panels powder coated white.

IS6 - Industry Standards -

NEMA Type 3R, 4, 4X, 12 & Type 13
UL Listed Type 3R, 4, 4X & 12
CSA Type 3R, 4, 4X & 12
IEC 60529 IP66

***Special Instructions apply for IS3, IS4 and IS6 to maintain the environmental rating of Type 3R for these parts. See the Special Instructions on the Industry Standards page in the Technical Information Section.

STAINLESS STEEL XD HEAVY DUTY FREE-STANDING ENCLOSURES WITH EXTERNAL DISCONNECT ENCLOSURES INSTALLED

SINGLE-DOOR ENCLOSURES

ENCLOSURE PRODUCT CODE S2						SUB-PANEL (P3)			
Catalog No.	Height (A)	Width (B)	Depth (C)	Industry Standard	List Price	Catalog No.	Panel Height (E)	Panel Width (F)	List Price
SCE-72XD2818SS	72.00	27.50	18.00	IS6	8,195.10	SCE-64P25**	60.00	21.75	Included
SCE-72XD3418SS	72.00	33.50	18.00	IS6	8,805.44	SCE-64P31**	60.00	27.75	Included
SCE-72XD4018SS	72.00	39.50	18.00	IS6	9,415.82	SCE-64P37**	60.00	33.75	Included
SCE-84XD4018SS	84.00	39.50	18.00	IS6	10,180.90	SCE-76P37**	72.00	33.75	Included
SCE-90XD4018SS	90.00	39.50	18.00	IS6	10,722.50	SCE-82P37**	78.00	33.75	Included

TWO-DOOR ENCLOSURES

ENCLOSURE PRODUCT CODE S2						SUB-PANEL (P3)			
Catalog No.	Height (A)	Width (B)	Depth (C)	Industry Standard	List Price	Catalog No.	Panel Height (E)	Panel Width (F)	List Price
SCE-72XD5418SS	72.00	53.75	18.00	IS6	12,450.44	SCE-64P52**	60.00	48.00	Included
SCE-72XD6618SS	72.00	65.75	18.00	IS6	13,705.52	SCE-64P64**	60.00	60.00	Included
SCE-72XD7818SS	72.00	77.75	18.00	IS6	14,956.34	SCE-64P76**	60.00	72.00	Included
SCE-84XD7818SS	84.00	77.75	18.00	IS6	16,318.93	SCE-76P76**	72.00	72.00	Included
SCE-90XD7818SS	90.00	77.75	18.00	IS6	17,251.64	SCE-82P76**	78.00	72.00	Included

THREE-DOOR ENCLOSURES

ENCLOSURE PRODUCT CODE S2						SUB-PANEL (P3)			
Catalog No.	Height (A)	Width (B)	Depth (C)	Industry Standard	List Price	Catalog No.	Panel Height (E)	Panel Width (F)	List Price
SCE-72XD3EQ18SS	72.00	99.50	18.00	IS6	17,376.33	SCE-64P31** & SCE-64P37**	60.00	27.75	Included
						SCE-64P37**	60.00	33.75	Included
SCE-72XD3EW18SS	72.00	117.50	18.00	IS6	19,237.48	SCE-76P37** & SCE-64P37**	72.00	33.75	Included
						SCE-64P37**	60.00	33.75	Included
SCE-84XD3EW18SS	84.00	117.50	18.00	IS6	21,154.54	SCE-76P37** & SCE-76P37**	72.00	33.75	Included
						SCE-76P37**	72.00	33.75	Included



**Sub-panel included with enclosure. Replacement panels can be ordered. Prices found in the accessory section.

Phone (989) 799-6871
Fax (989) 799-4524



1 Operator System Enclosures
2 Wall-Mount Enclosures
3 Free-Standing & Floor-Mounted Enclosures
4 Modular Enclosures
5 Operator System Enclosures (Stainless Steel)
6 Wall-Mount Enclosures (Stainless Steel)
7 Free-Standing & Floor-Mounted Enclosures (Stainless Steel)
8 Non-Metallic Enclosures
9 Accessories
10 Technical Information
11 Index

STAINLESS STEEL XD HEAVY DUTY FREE-STANDING ENCLOSURES WITH EXTERNAL DISCONNECT ENCLOSURE INSTALLED

TECHNICAL DATA

SINGLE-DOOR ENCLOSURE

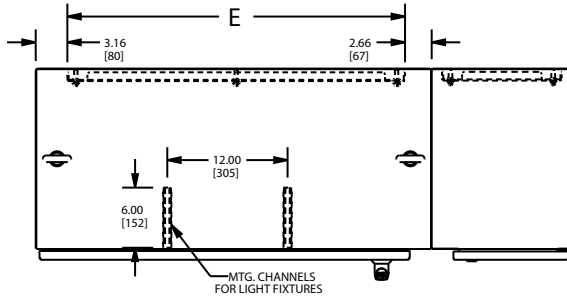

STANDARD DISCONNECTS:
 F = 0.00 [0] when A = 72.00 [1829]
 F = 5.50 [138] when A = 84.00 [2134]
 F = 8.50 [216] when A = 90.00 [2286]

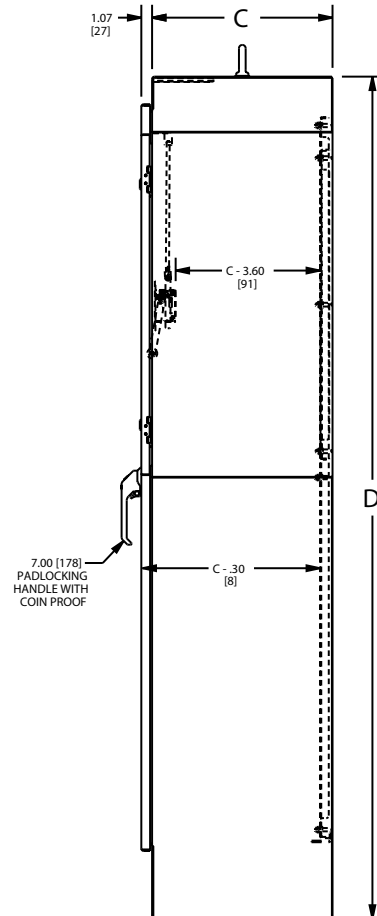
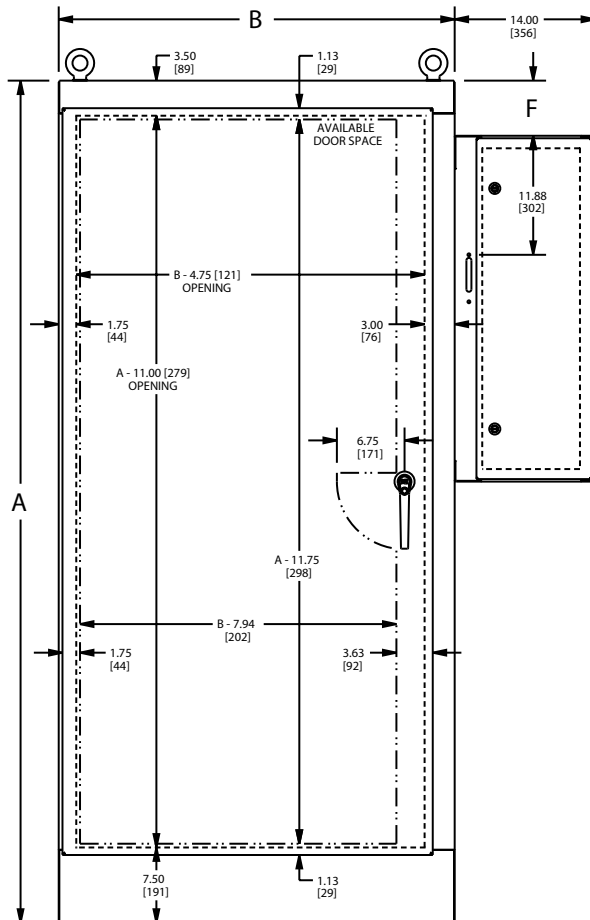

STAINLESS STEEL XD HEAVY DUTY FREE-STANDING ENCLOSURES WITH EXTERNAL DISCONNECT ENCLOSURE INSTALLED

TECHNICAL DATA

TWO-DOOR ENCLOSURE

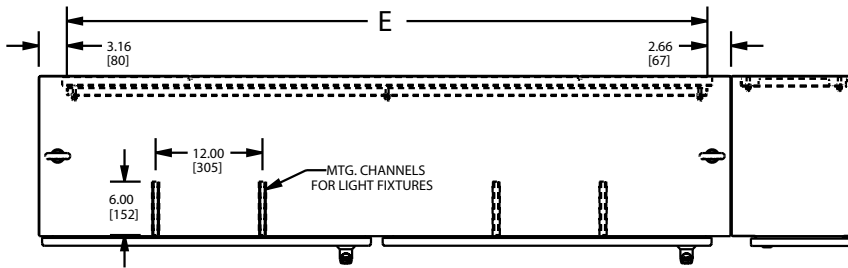

STANDARD DISCONNECTS:
 F = 0.00 [0] when A = 72.00 [1829]
 F = 5.50 [138] when A = 84.00 [2134]
 F = 8.50 [216] when A = 90.00 [2286]

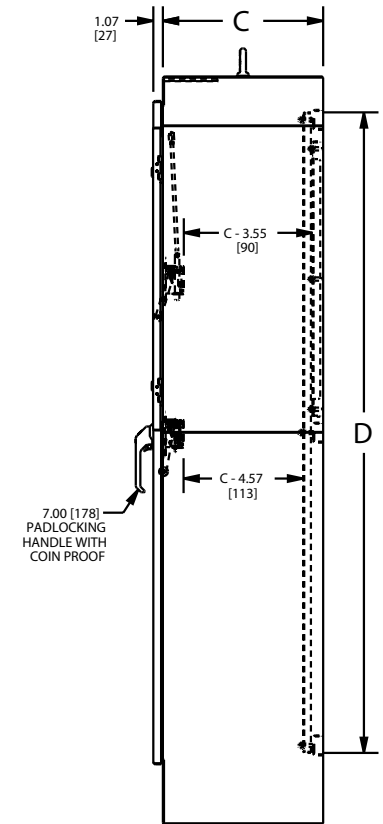
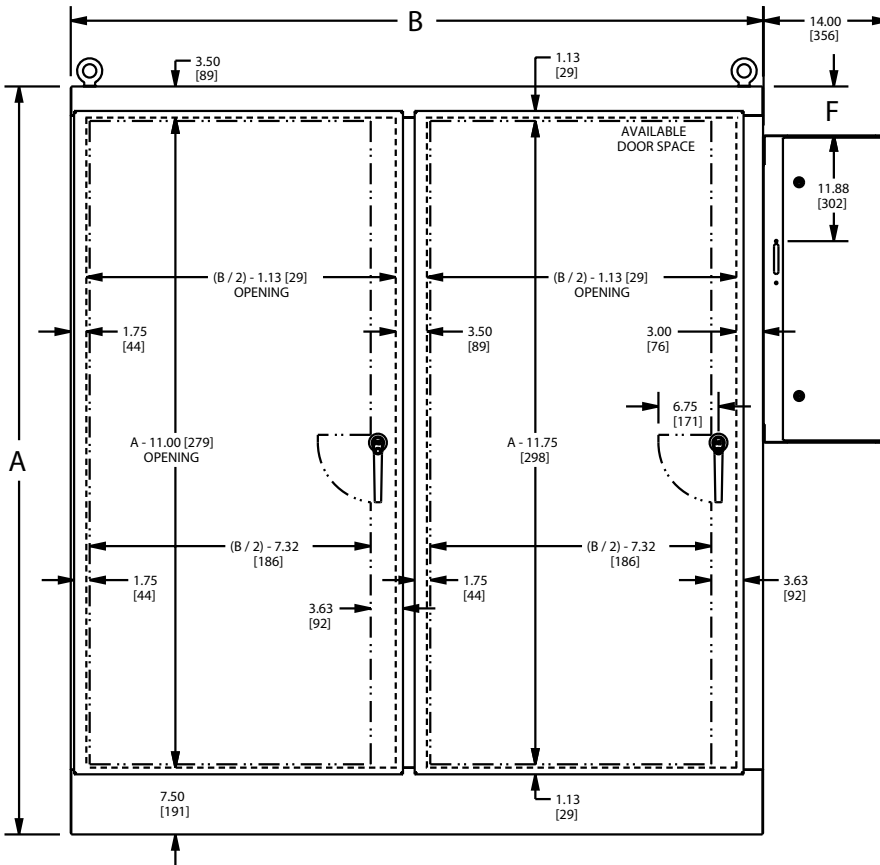

Phone (989) 799-6871
 Fax (989) 799-4524



1 Operator System Enclosures
 2 Wall-Mount Enclosures
 3 Free-Standing & Floor-Mounted Enclosures
 4 Modular Enclosures
 5 Operator System Enclosures (Stainless Steel)
 6 Wall-Mount Enclosures (Stainless Steel)
 7 Free-Standing & Floor-Mounted Enclosures (Stainless Steel)
 8 Non-Metallic Enclosures
 9 Accessories
 10 Technical Information
 11 Index

STAINLESS STEEL XD HEAVY DUTY FREE-STANDING ENCLOSURES WITH EXTERNAL DISCONNECT ENCLOSURE INSTALLED

TECHNICAL DATA

THREE-DOOR ENCLOSURE

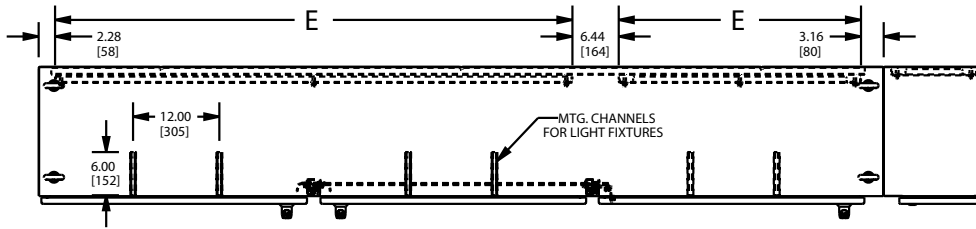

STANDARD DISCONNECTS:
 F = 0.00 [0] when A = 72.00 [1829]
 F = 5.50 [138] when A = 84.00 [2134]
 F = 8.50 [216] when A = 90.00 [2286]

